

Milford Street

SOUTHVILLE

APPROXIMATE FLOOR AREA
147.6 SQM / 1589 SQFT

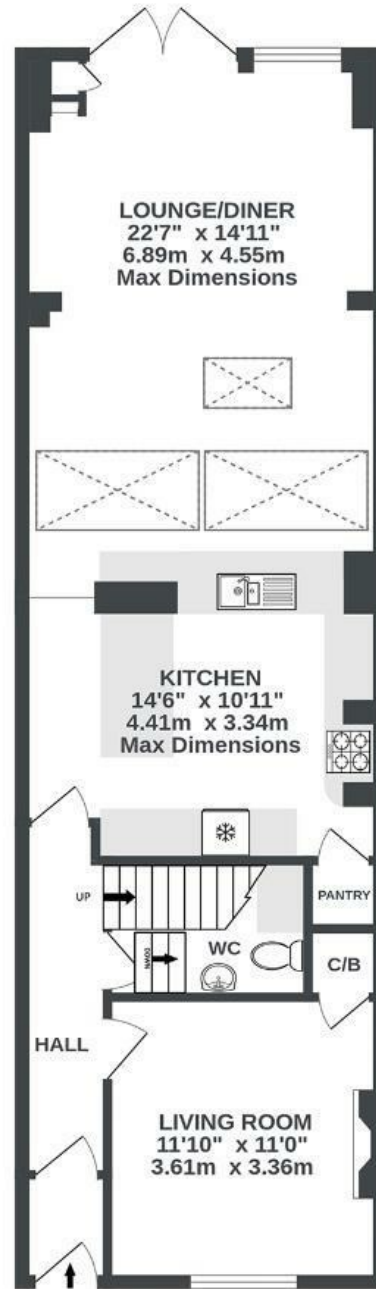

GROUND FLOOR
722 sq.ft. (67.1 sq.m.) approx.

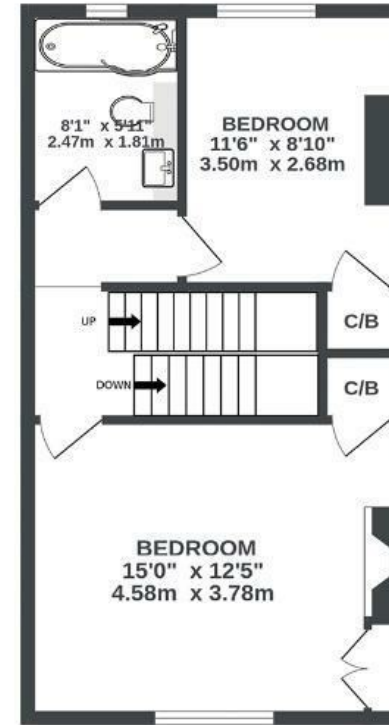

1ST FLOOR
432 sq.ft. (40.1 sq.m.) approx.

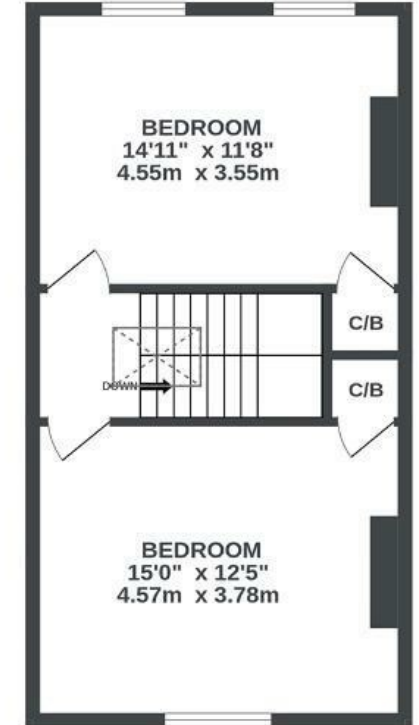

2ND FLOOR
435 sq.ft. (40.4 sq.m.) approx.



Illustrations are for reference purposes only, measurements are approximate, not to scale.

Boardwalk

Milford Street , BRISTOL



£850,000



4 Bedrooms



BS3 1EE



2 Bathrooms

"It's been a wonderful home to bring up a family in. Lots of indoor and outdoor space, lots of light. But the best thing has been living in Milford St - it's a very special street and a great community."

